

REVISION RECORD				
REV	ECO	DESCRIPTION	DRFT	CHKD

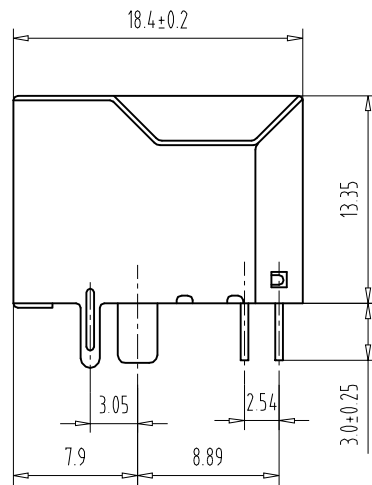
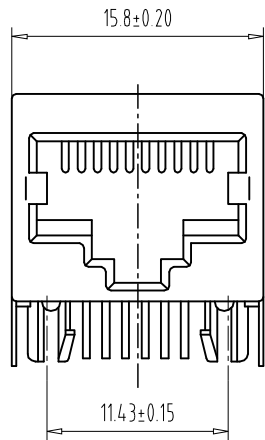

NOTES:

MATERIAL :

- | | |
|---------------------|---|
| 1. HOUSING MATERIAL | : GLASS FILLED POLYESTER UL94V-0. |
| 2. CONTACT MATERIAL | : PHOSPHOR BRONZE ϕ 0.45mm. |
| 3. PLATING | : GOLD PLATING OVER NICKEL. |
| 4. SHIELD | : 0.20mm THICKNESS COPPER ALLOY WITH NICKEL PLATED. |

ELECTRICAL:

- | | |
|---------------------------------------|-------------------------------|
| 1. VOLTAGE RATING | : 125 VAC RMS. |
| 2. CURRENT RATING | : 1.5 AMP. |
| 3. CONTACT RESISTANCE | : 30 MILLIOHMS MAX. |
| 4. INSULATION RESISTANCE | : 500 MEGOHMS MIN @ 500V DC . |
| 5. DIELECTRIC WITHSTANDING RESISTANCE | : 1000V AC RMS 50Hz. 1MIN. |

MECHANICAL:

- | | |
|-----------------------------|-------------------|
| 1. DURRABILITY | : 750 CYCLES MIN. |
| 2. PCB RETENTION PRE-SOLDER | : 1 LB MIN. |

ENVIRONMENTAL:

- | | |
|--------------|----------------|
| 1. STORAGE | : -40°C~+85°C |
| 2. OPERATION | : 0°C TO 70°C. |

PART NUMBER

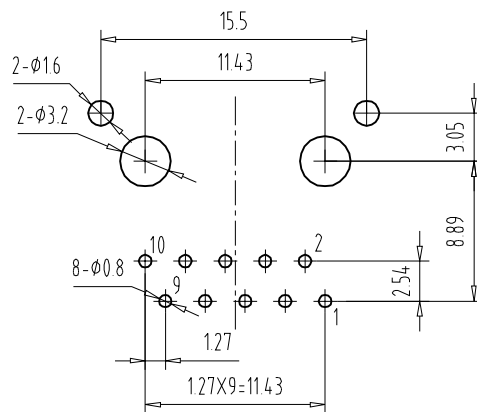
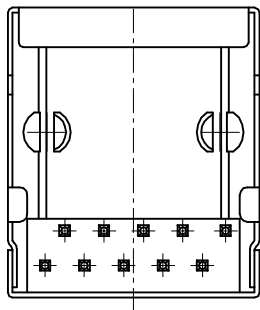

PC Board Layout
Component Side Shown

TOLERANCES EXCEPT AS NOTED MM : .1 ± 0.15 .01 ± 0.025 .01 ± 0.15 ANGLES ± 0.5 THIRD ANGLE PROJECTION	DFTO: SHB CHKD: LANBO MFO:	DATE: 2007.05.03 DATE: 2007.05.03 DATE:	Coorle 库乐科技 TITLE 56 1X1 SIDE ENTRY JACK 10P10C W/ SHIELD		
	APPVL: MATERIAL :	DATE:			DRAWING NO. TES661002 /PART NO.
	QTY : FINISH : SCALE :	DO NOT SCALE DRAWING		SHEET X OF Y	A